

**Dimensions**

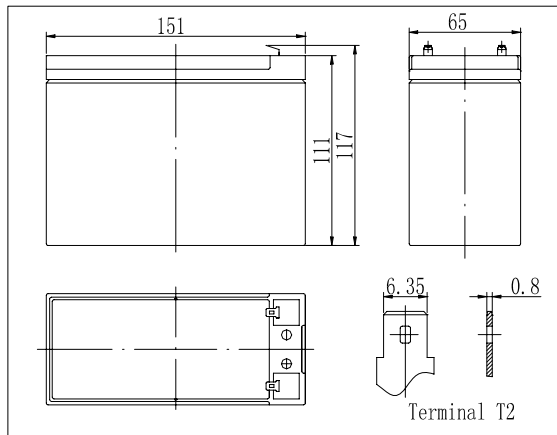

**Specifications**

Nominal Voltage	12 V	
Capacity(20HR, 25°C)	10Ah	
Dimension	Length	151mm (5.94inch)
	Width	65mm (2.56inch)
	Height	111mm (4.37inch)
	Total Height	117mm (4.61inch)
Approx. Weight	2.9kg (6.39lbs)	
Internal resistance (Fully charged, 25°C)	Approx. 22mΩ	
Capacity affected by temperature (20HR)	40°C	102%
	25°C	100%
	0°C	85%
	-15°C	65%
Self-discharge (25°C)	3 month	Remaining Capacity: 91%
	6 month	Remaining Capacity: 82%
	12 month	Remaining Capacity: 65%
Nominal operating temperature	25°C ± 3°C (77°F ± 5°F)	
Operating temperature range	-15°C ~ 50°C (5°F ~ 122°F)	
Float charging voltage(25°C)	13.60 to 13.80V	
Cyclic charging voltage(25°C)	14.50 to 14.90V	
Maximum charging current	3A	
Terminal material	Copper	
Maximum discharge current	150A(5 sec.)	

- ◆ Absorbent glass mat technology;
- ◆ Recognized by UL & CE;
- ◆ ABS container.

**Constant Current Discharge Characteristics (A, 25°C)**

F.V/TIME	5min	10min	15min	30min	60min	3h	5h	10h	20h
9.60V	42.0	28.2	20.8	11.7	6.40	2.44	1.66	0.91	0.50
10.2V	39.9	26.8	20.0	11.2	6.14	2.40	1.64	0.90	0.50
10.8V	37.5	25.2	19.0	10.5	5.83	2.35	1.61	0.88	0.49

**Constant Power Discharge Characteristics (Watt, 25°C)**

F.V/TIME	5min	10min	15min	30min	60min	3h	5h	10h	20h
9.60V	469	318	237	134	74.1	29.0	19.8	10.9	6.00
10.2V	445	302	228	128	71.1	28.5	19.6	10.8	6.00
10.8V	419	284	217	120	67.5	27.9	19.2	10.6	5.88

**Charging Characteristics(25°C)**

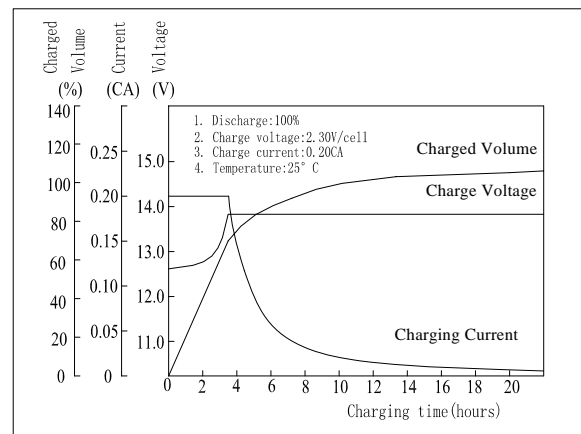

**Cycle Life(25°C)**

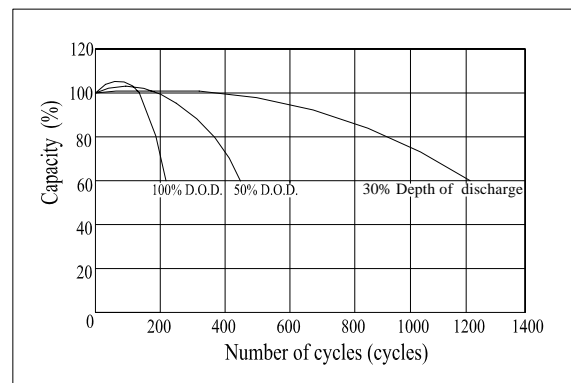

Note: Floating life at 20°C designed for 3 to 5 years.