

**Dimensions**

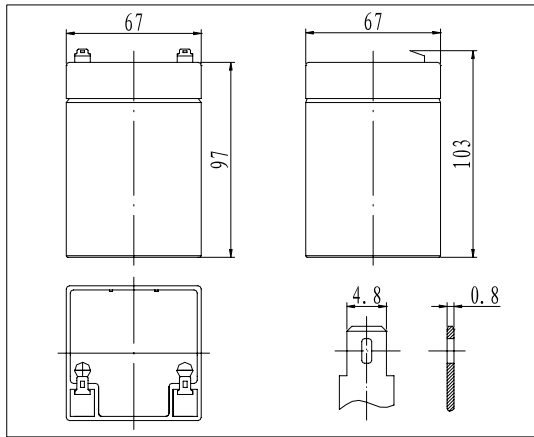

**Specifications**

Nominal Voltage	12 V	
Capacity(20HR, 25°C)	2.8Ah	
Dimension	Length	67mm (2.64inch)
	Width	67mm (2.64inch)
	Height	97mm (3.82inch)
	Total Height	103mm (4.06inch)
Approx. Weight	1.2kg (2.65lbs)	
Internal resistance (Fully charged, 25°C)	Approx. 45mΩ	
Capacity affected by temperature (20HR)	40°C	102%
	25°C	100%
	0°C	85%
	-15°C	65%
Self-discharge (25°C)	3 month	Remaining Capacity: 91%
	6 month	Remaining Capacity: 82%
	12 month	Remaining Capacity: 65%
Nominal operating temperature	25°C ± 3°C (77°F ± 5°F)	
Operating temperature range	-15°C ~ 50°C (5°F ~ 122°F)	
Float charging voltage(25°C)	13.60 to 13.80V	
Cyclic charging voltage(25°C)	14.50 to 14.90V	
Maximum charging current	0.84A	
Terminal material	Copper	
Maximum discharge current	42A(5 sec.)	

- ◆ Absorbent glass mat technology;
- ◆ Recognized by UL & CE;
- ◆ ABS container.

**Constant Current Discharge Characteristics (A, 25°C)**

F.V/TIME	5min	10min	15min	30min	60min	3h	5h	10h	20h
9.60V	11.5	7.20	5.50	3.10	1.83	0.71	0.46	0.25	0.14
10.2V	10.9	6.84	5.28	2.98	1.76	0.70	0.45	0.25	0.14
10.8V	10.2	6.43	5.02	2.83	1.67	0.69	0.44	0.25	0.14

**Constant Power Discharge Characteristics (Watt, 25°C)**

F.V/TIME	5min	10min	15min	30min	60min	3h	5h	10h	20h
9.60V	128	81.2	62.7	35.5	21.2	8.43	5.49	3.05	1.71
10.2V	122	77.2	60.2	34.2	20.4	8.32	5.37	3.02	1.69
10.8V	114	72.5	57.2	32.4	19.3	8.20	5.25	3.02	1.68

**Charging Characteristics(25°C)**

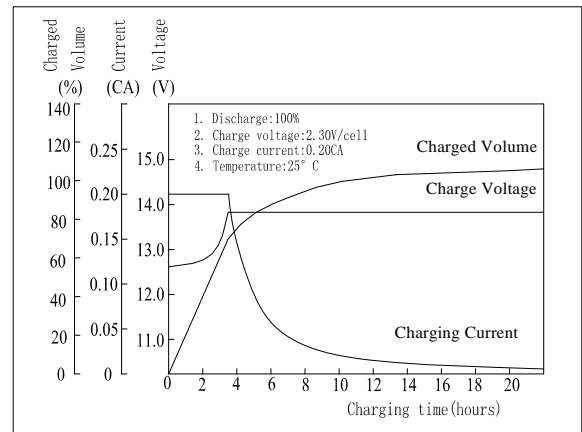

**Cycle Life(25°C)**

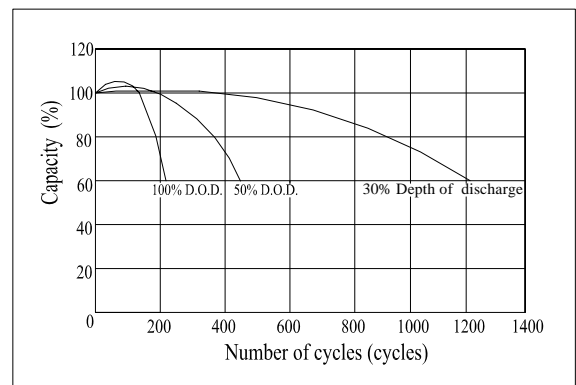

Note: Floating life at 20°C designed for 3 to 5 years.